

ZINTL®



PREMIUM INTERLOCKING
ALUMINIUM CLADDING SYSTEM

DESIGN PERFORMANCE



Zintl® aluminium cladding system is a timelessly elegant and enduring material that offers a world of design possibilities. This high-performance cladding is available in a range of interlocking weatherboard profiles to suit any project.

Zintl® provides architects with façade profiles that are versatile and 100% non-combustible, certified to AS1530.1. Combining sophisticated style, extraordinary fire performance and efficient installation, this cladding system is ideal for residential, commercial, education, sporting and health care projects. Designed for quick and cost effective installation, Zintl® requires minimal ongoing maintenance and can be customised to suit each project.

Zintl® aluminium cladding is offered in a wide range of Interpon and Dulux powder coated finishes as well as a selection of anodised and wood grain architectural finishes, providing a beautifully refined aesthetic. With its mix of natural, bold and subtle hues, Zintl® is perfect for any budget or environment. Its durability makes it particularly well suited for coastal properties and high traffic areas.

ZINTL® BENEFITS

Customisable

With its six unique profile designs and broad range of finishes and colours, Zintl® enhances any project.

100% non-combustible to AS1530.1

Zintl® is NCC compliant, a rating that helps streamline the building approvals process.

Easy to install

Zintl®'s interlocking system is easy to use, which means faster installation, improved site costs and superb alignment.

Powder coated finish

Zintl® features a superior long-lasting finish through trusted Interpon and Dulux ranges. Powder coating warranties up to 30 years apply.

High quality marine grade aluminium

Zintl® is designed to be corrosion resistant, which makes it an ideal choice for all locations.

Competitively priced

Zintl® is an affordable and high-quality cladding option.

Stocked in Australia

As Zintl® is stocked locally, there are reduced lead times for delivery.

Expert advice

Zintl® offers a team of experts with strong industry, design and technical knowledge available to assist with enquires.

Warranty

Zintl® offers high colour retention and will not oxidise over time. Surface finish warranties available in 10, 25 or 30 years, based on powder coat range selected.

ZINTL® TECHNICAL DATA SHEET

Properties	Units	Values
Alloy		6063
Temper		T5
Standard thickness	mm	1.4 - 2.2
Painted weight	kg/m ²	0.642kg/m to 1.575kg/m
Raw density	kg/m ³	2700
Young's modulus (E)	GPa	68.3
Tensile strength (25°C)	MPa	220
Yield strength (25°C)	MPa	180
Shear strength	MPa	11
Fatigue strength	MPa	117
Elastic modulus	MPa	69
0.2% proof stress	MPa	>170
Elongation	%	12
Linear thermal expansion		2.4mm/m at 100° temperature difference
Melting range	°C	630-660
Electrical conductivity - Equal volume	MS/m	32
Electrical conductivity - Equal mass	MS/m	105
Thermal conductivity	W/m.K	201-218
Sound adsorption factor	NCR	0.05
Sound reflection	%	95

ZINTL® SYSTEMS AND PROFILES



Shiplap 150

- 150mm finished face
- Horizontal and vertical install
- Contemporary, traditional weatherboard appearance
- 3.5m, 5.0m and 6.5m lengths



Step 60

- 120mm finished face
- Horizontal install only
- Stepped weatherboard appearance
- 3.5m, 5.0m and 6.5m lengths



Step 120

- 120mm finished face
- Horizontal install only
- Stepped weatherboard appearance
- 3.5m, 5.0m and 6.5m lengths





Linea 190

- 190mm finished face
- Horizontal and vertical install
- Sleek and contemporary flat board appearance
- 3.5m, 5.0m and 6.5m lengths



Shadow 200

- 200mm finished face
- Horizontal and vertical install
- A flat continuous board with negative detail
- 3.5m, 5.0m and 6.5m lengths



Standing Seam 190

- 190mm finished face
- Vertical install only
- A vertical interlocking profile with single standing seam
- 3.5m, 5.0m and 6.5m lengths



FIXING DETAILS

Horizontal Board

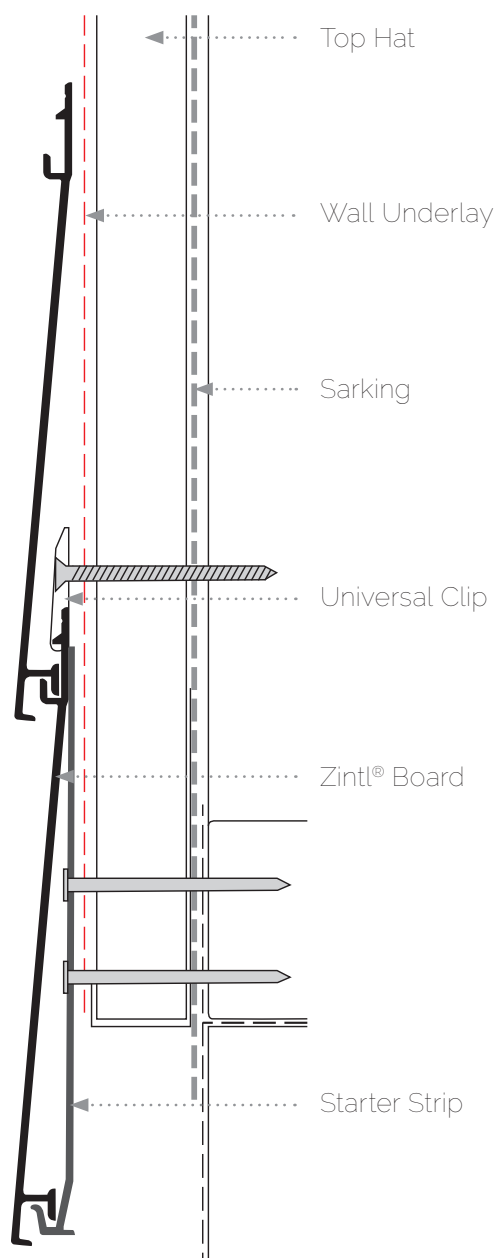

Vertical Board

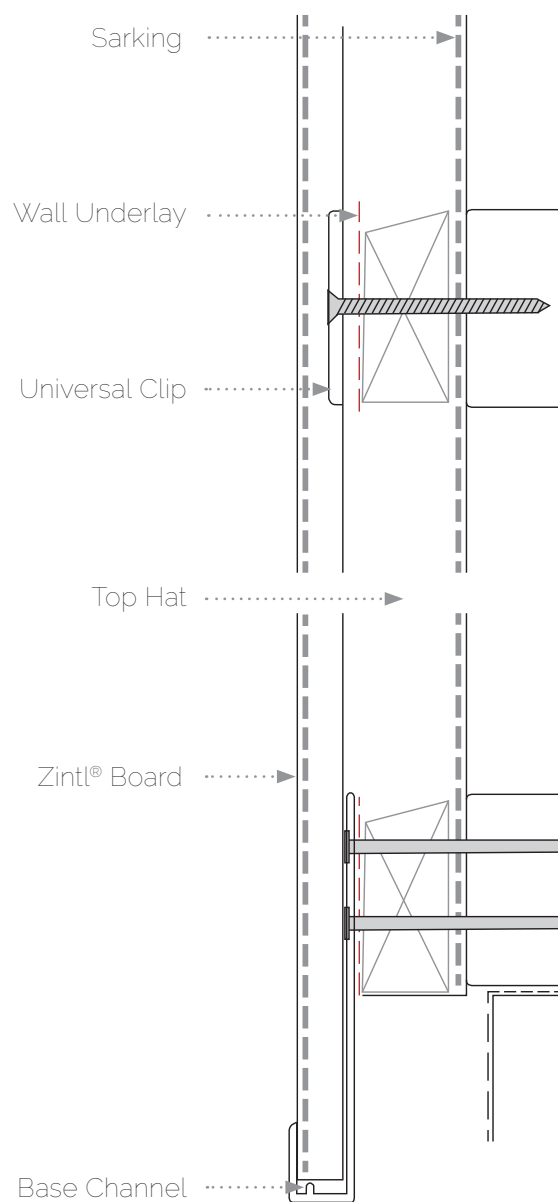

C L E A N I N G I N F O R M A T I O N

To ensure Zintl® is maintained to the highest standard, regular cleaning is recommended.

Further information can be found in the cleaning and maintenance brochures on the Interpon and Dulux websites.

Interpon link: <https://www.specifyinterpon.com.au/wp-content/uploads/interpon-care-and-maintenance.pdf>

Dulux Link: <https://duluxpowders.com.au/information/care-maintenance/>



A S U S T A I N A B L E C H O I C E

Zintl® aluminium cladding is an excellent choice to enhance the sustainability of buildings due to its exceptional corrosion resistance and recyclability.

Our Zintl® solid aluminium boards are 100% recyclable, offering an eco-friendly solution. Up to 95% less energy is required in the recycling of aluminium in comparison to other primary metals, ensuring a reduction in emissions.

The ZINTL logo is rendered in a clean, modern, sans-serif typeface. The letters are black and spaced evenly. A small registered trademark symbol (®) is located at the top right of the letter 'L'.

ZINTL®

The logo for HVG façades. It features the letters 'HVG' in a bold, red, sans-serif font, followed by the word 'façades' in a black, lowercase, sans-serif font. The 'façades' text is slightly offset to the right.

By **HVG** façades

hvgfacades.com.au | 1300 881 712

SYDNEY
29 Henderson Street
Turrella NSW 2205

MELBOURNE
25 West Park Drive
Derrimut VIC 3026

BRISBANE
128 Mica Street
Carole Park QLD 4300

PERTH
72 Bushland Ridge
Bibra Lake WA 6163

ADELAIDE
57 Barnes Avenue
Marleston SA 5033

Version 1.1