

Kingspan Insulated Panels  
Australia

# KS1100/ KS1200RL Roofliner Panel

## Installation Guide



# KS1100/KS1200RL Roofliner Panel

## Components

### KS1100/KS1200RL Roofliner Panel

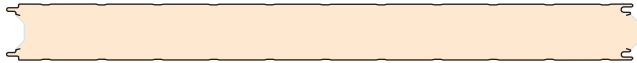

#### Primary fastener with 8mm neoprene washer

(Carbon Steel)  
(Not supplied by Kingspan)



Pre-coring of the external panel face may be required with some spreader plates (Not supplied by Kingspan)



#### 120x2mm EPDM sealing tape

(Code: EPDM120X2X40M)



#### 6x4mm Ø butyl tape sealant

(Code: SEXT)



#### Non-setting gun-grade butyl sealant

(Not supplied by Kingspan)



#### 40mm Ø stainless steel Spreader plate

(With EPDM seal)  
(Not supplied by Kingspan)

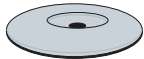

#### Recessed washer

(Not supplied by Kingspan)

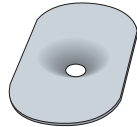

#### Roll of butyl nylon tape

(Code: SEXT501)



#### Purlin extension plate

(Not supplied by Kingspan)



#### Fire rated canister foam

(Not supplied by Kingspan)



This installation guide should be read in conjunction with the 'project specific' design drawings and method statements.

Although this 'installation guide' is deemed to be correct at the time of publication, Kingspan reserve the right to amend the information at any time in the future.

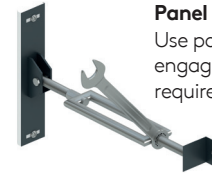

#### Panel clamp

Use panel clamps to ensure full engagement of panel joint when required

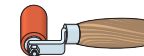

#### Roller - Joint Tape

(Not supplied by Kingspan)

# KS1100/KS1200RL Roofliner Panel

## Note:

- Ensure steelwork is suitably lined, levelled and within tolerance.
- Fasteners to suit project specification requirements (Material: carbon steel)
- Gun-grade sealant referred to is non-setting butyl sealant.
- All sealants to suit project specification requirements.
- Minimum bearing of panel end onto purlin is 60mm
- Ensure that adequate panel to panel compression is achieved
- The system is suitable for various roof applications: Standing seam, Single ply membrane etc.
- Some systems may require a breather / vapour membrane or other control layer.
- Minimum of 3 primary fasteners per support
- Number of fasteners per support must be calculated based on project specific factors
- Minimum 40mm Ø galvanised steel spreader plate.
- Primary fasteners to be located less than 100mm from edge of panel
- Vacuum Tensioning Kit should only be used for flat panel profiles
- Clean swarf off panels immediately when created.
- Roof is not fully watertight until membrane / third party cladding material has been installed over the panel.
- Ensure panel joints are pulled tight to adjacent panels to close any gaps as works progress.
- This installation guide provides generic guidance on installation methods, however, should be read in conjunction with project specific specifications and construction details.
- Install fasteners with recommended screw gun speed selection for type of steel, use correct socket and drive bit, including depth – locating nose piece, unless fastener has feature to prevent overdriving, in line with fastener manufacturers.
- Use panel clamps to ensure full engagement of panel joint when required.
- Protective film to be removed from external weather face of panel & internal liner where applicable prior to installation.

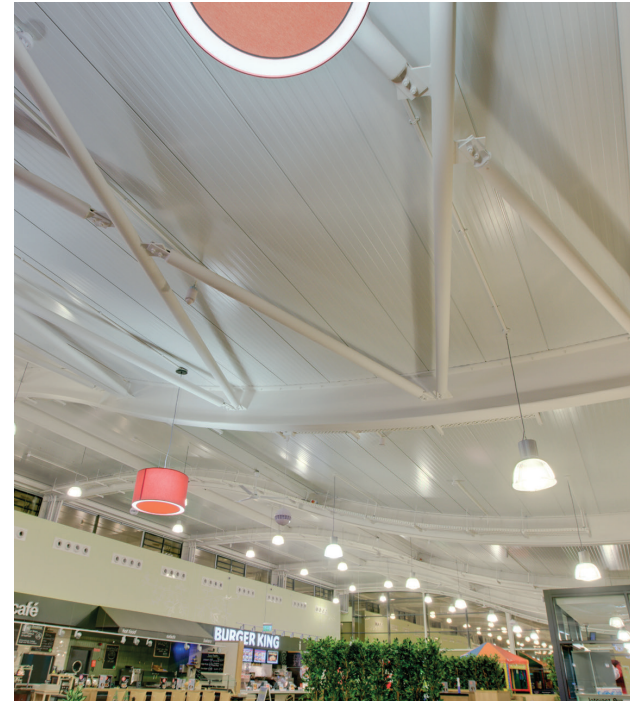

Please contact Kingspan Technical Services Department for guidance:

- Internal air seals
- High humidity & hygiene internal environment
- Project specific advise

# KS1100/KS1200RL Roofliner Panel

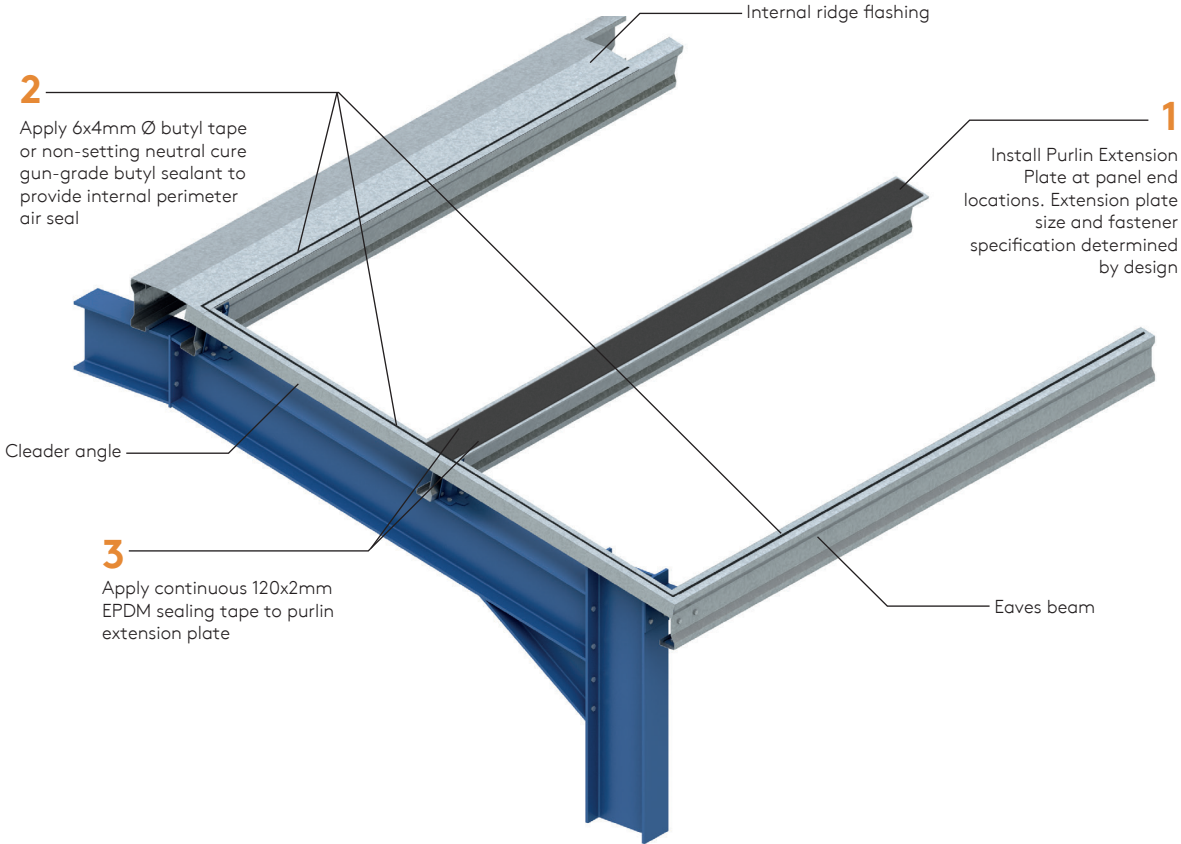

# KS1100/KS1200RL Roofliner Panel

4

Locate first panel (**P1**) ensuring it is bearing evenly on the galvanised extension plate (**Minimum overall panel bearing is 120mm**).

Fix panel (**P1**) with 3No. primary fasteners with 40mm  $\varnothing$  s/steel spreader plate, per purlin (**minimum**) subject to wind loadings.

**Note:** Coring of the external panel face may be required when using recessed washer

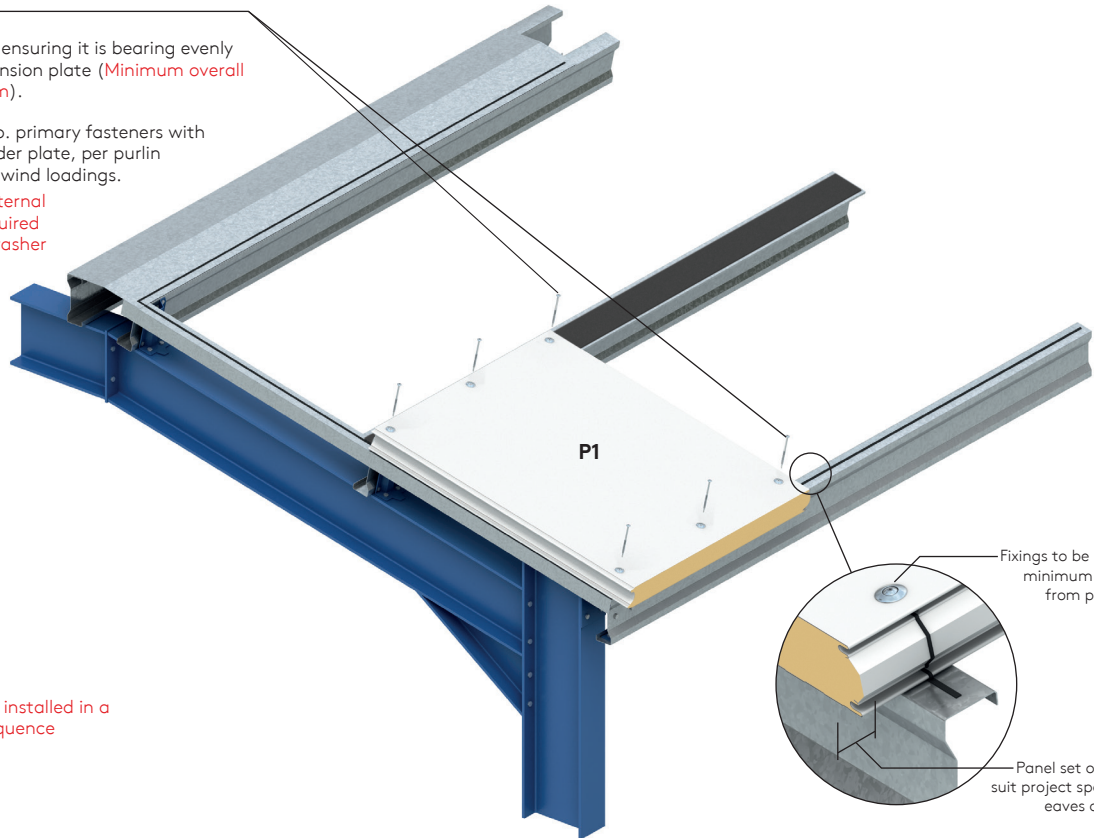

**Note:** Panels can be installed in a coursed or tiered sequence

# KS1100/KS1200RL Roofliner Panel

5

Lay second panel (P2) ensuring it is bearing evenly on the galvanised extension plate (Minimum overall panel bearing is 120mm). Panel butt joint should be approx. 10mm.

Fix panel (P2) with 3No. primary fasteners with 40mm Ø s/steel spreader plate, per purlin (minimum) subject to wind loadings

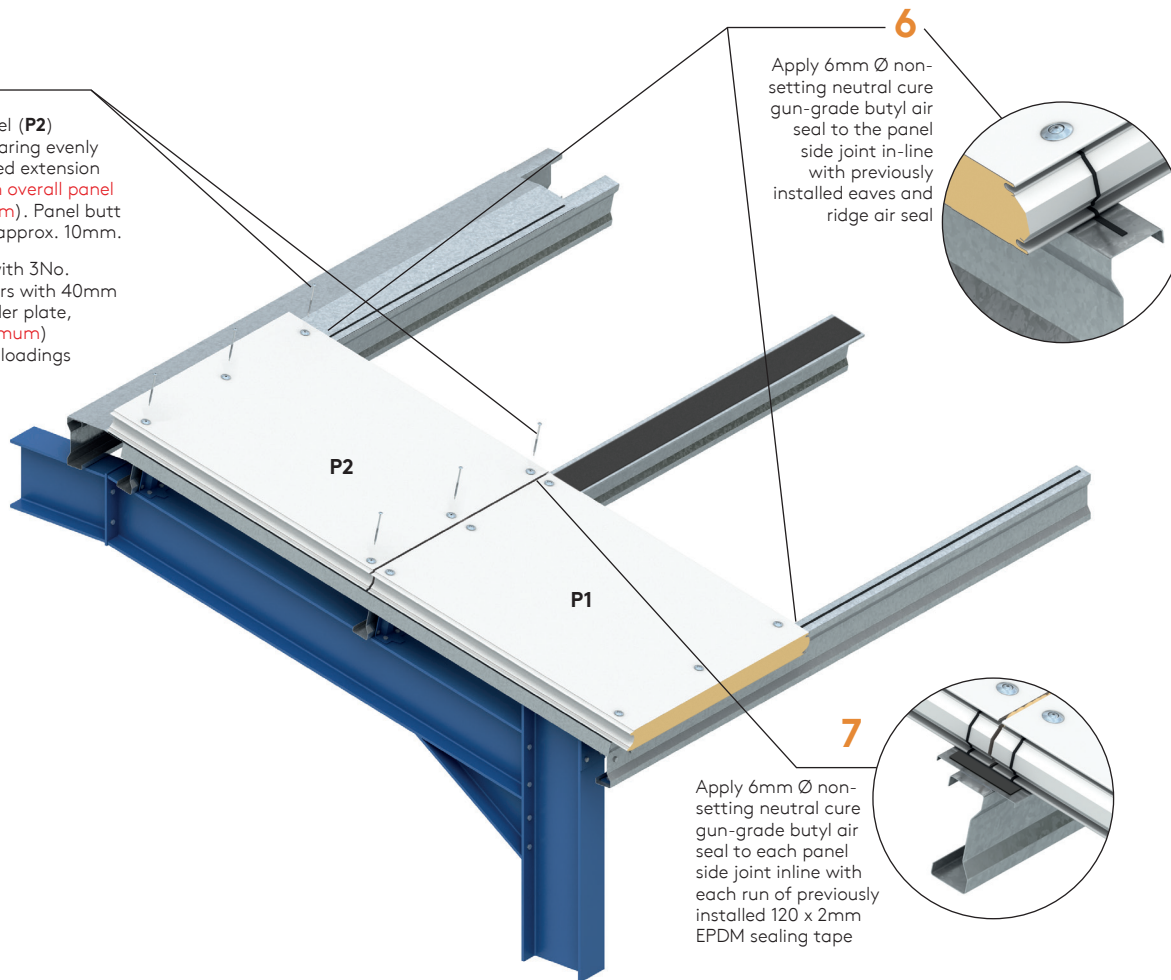

# KS1100/KS1200RL Roofliner Panel

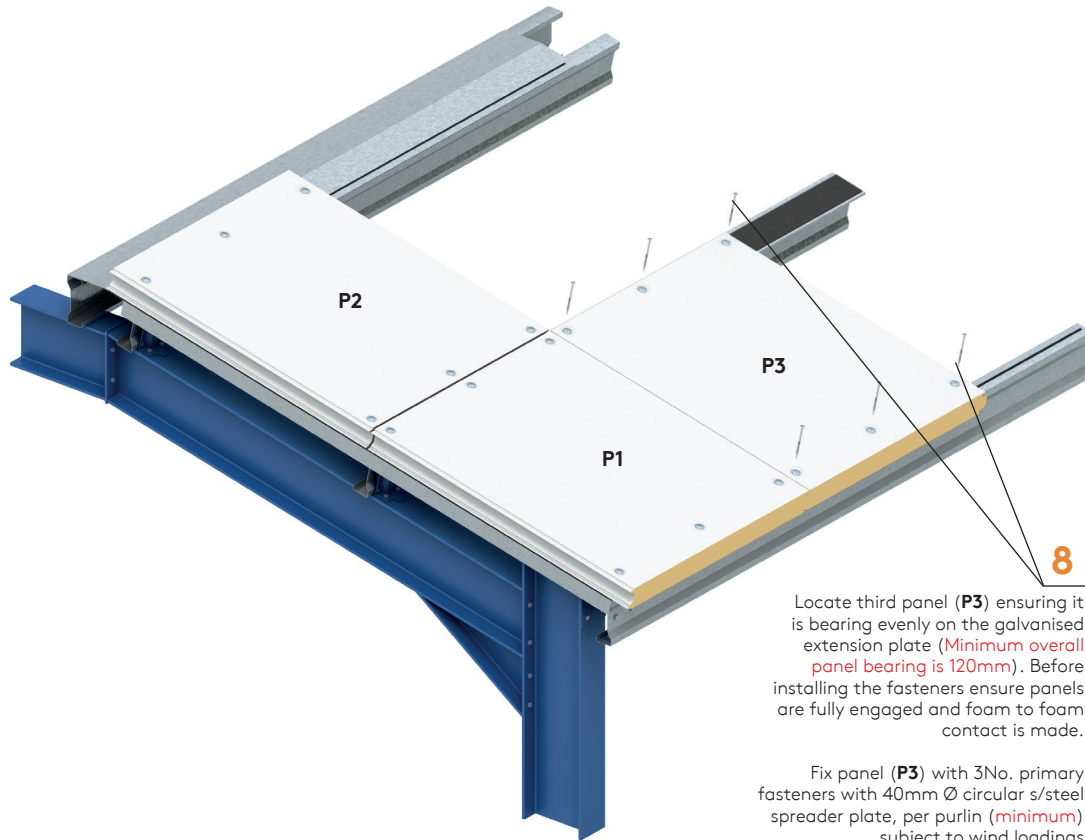

8  
Locate third panel (**P3**) ensuring it is bearing evenly on the galvanised extension plate (**Minimum overall panel bearing is 120mm**). Before installing the fasteners ensure panels are fully engaged and foam to foam contact is made.

Fix panel (**P3**) with 3No. primary fasteners with 40mm Ø circular s/steel spreader plate, per purlin (**minimum**) subject to wind loadings

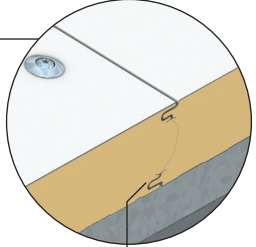

Ensure foam to foam contact is made

# KS1100/KS1200RL Roofliner Panel

10

10mm gap between panel ends to be filled using fire rated canister foam and cut flush prior to nylon backed butyl tape application

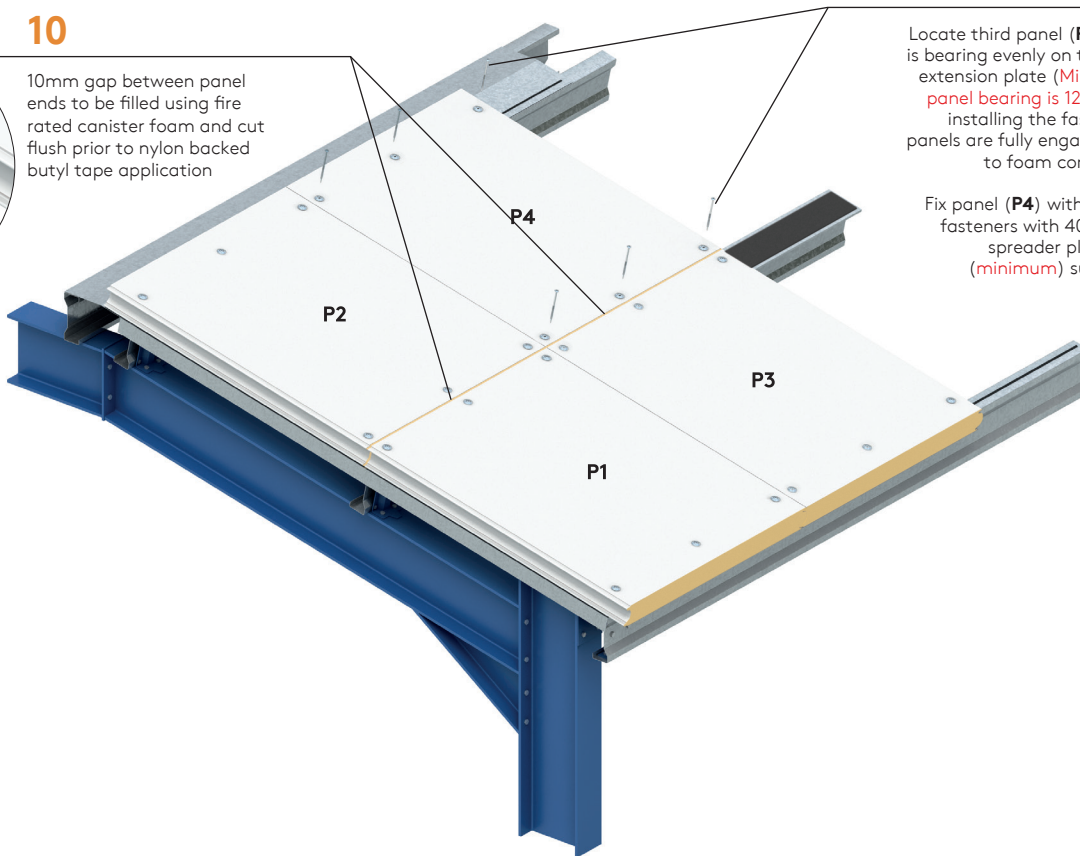
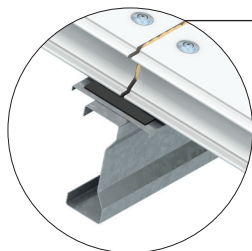

Locate third panel (**P4**) ensuring it is bearing evenly on the galvanised extension plate (**Minimum overall panel bearing is 120mm**). Before installing the fasteners ensure panels are fully engaged and foam to foam contact is made.

Fix panel (**P4**) with 3No. primary fasteners with 40mm Ø s/steel spreader plate, per purlin (**minimum**) subject to wind loadings



# KS1100/KS1200RL Roofliner Panel

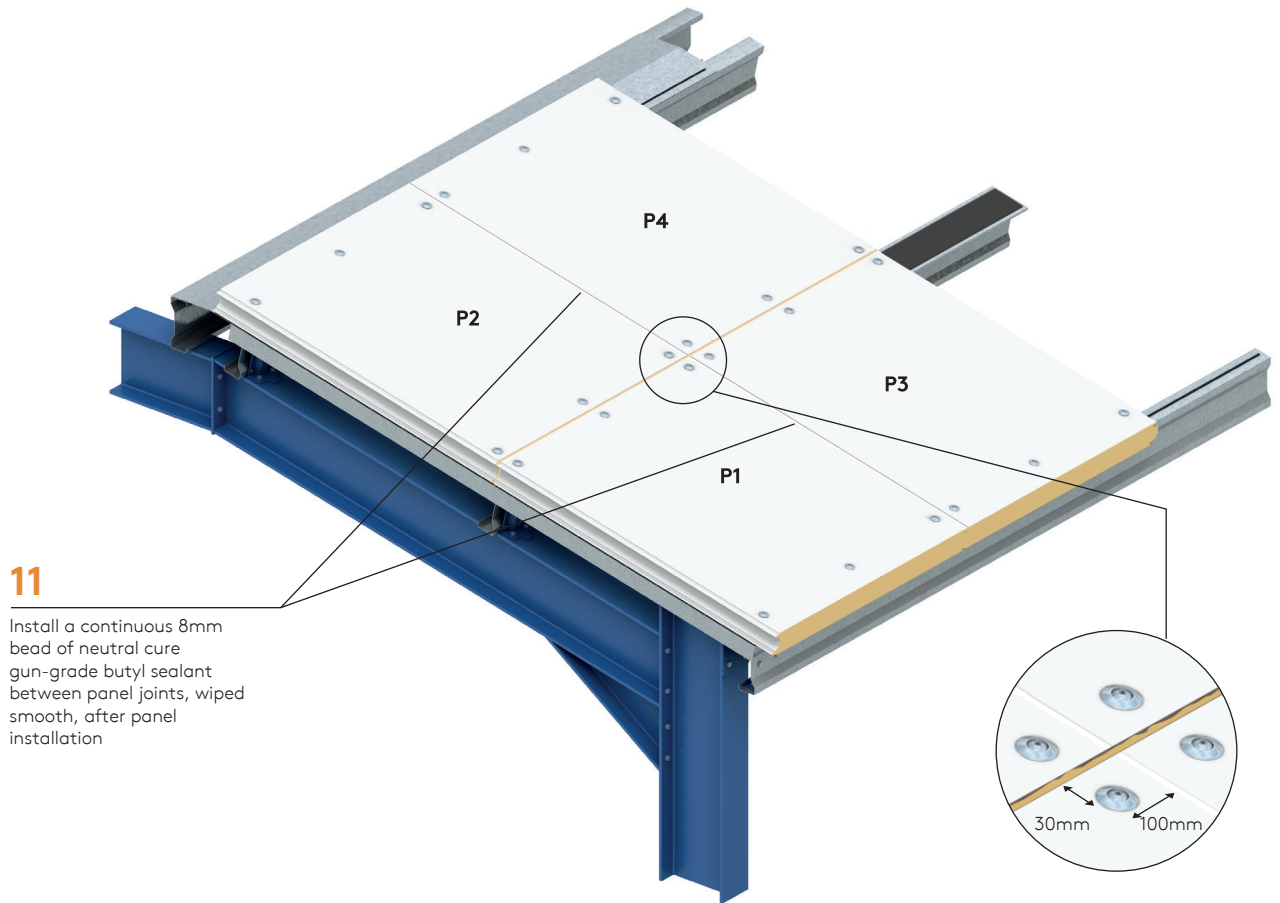

## KS1100/KS1200RL Roofliner Panel

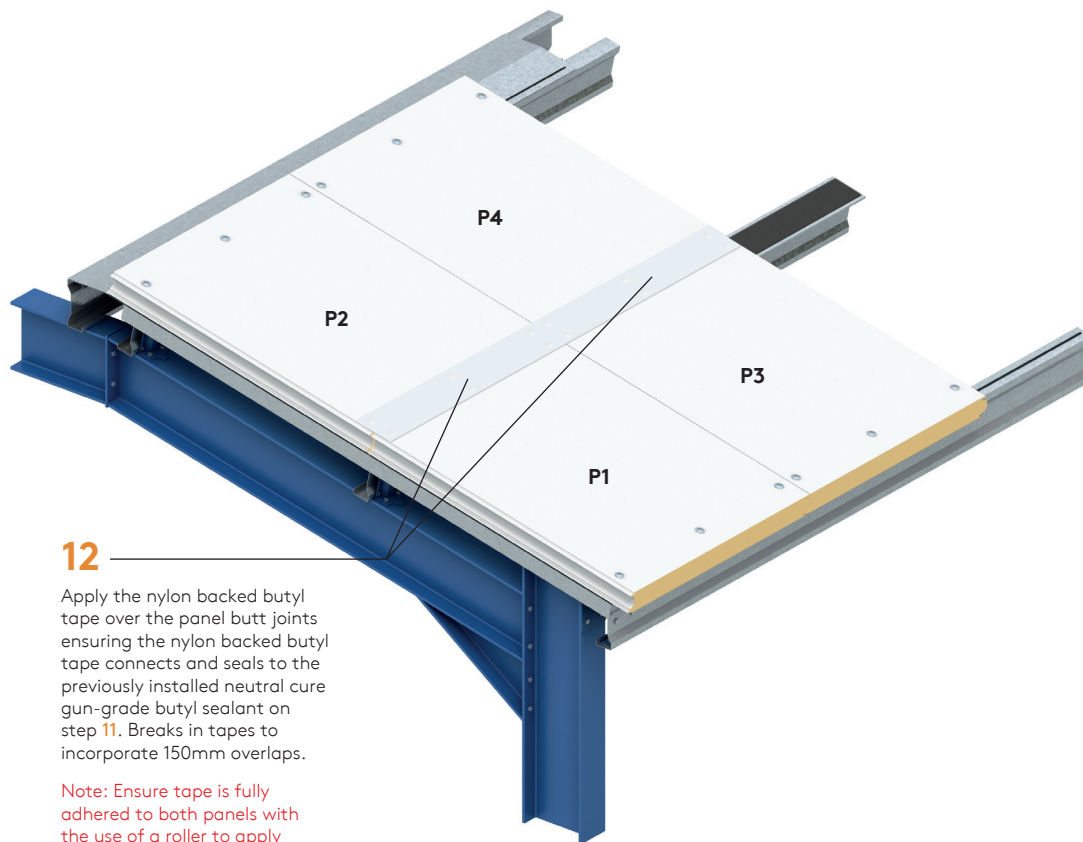

**12**

Apply the nylon backed butyl tape over the panel butt joints ensuring the nylon backed butyl tape connects and seals to the previously installed neutral cure gun-grade butyl sealant on step 11. Breaks in tapes to incorporate 150mm overlaps.

**Note:** Ensure tape is fully adhered to both panels with the use of a roller to apply pressure

# KS1100/KS1200RL Roofliner Panel

**13**

When using the recessed washer, apply a patch of nylon backed butyl tape over the washer to weather seal

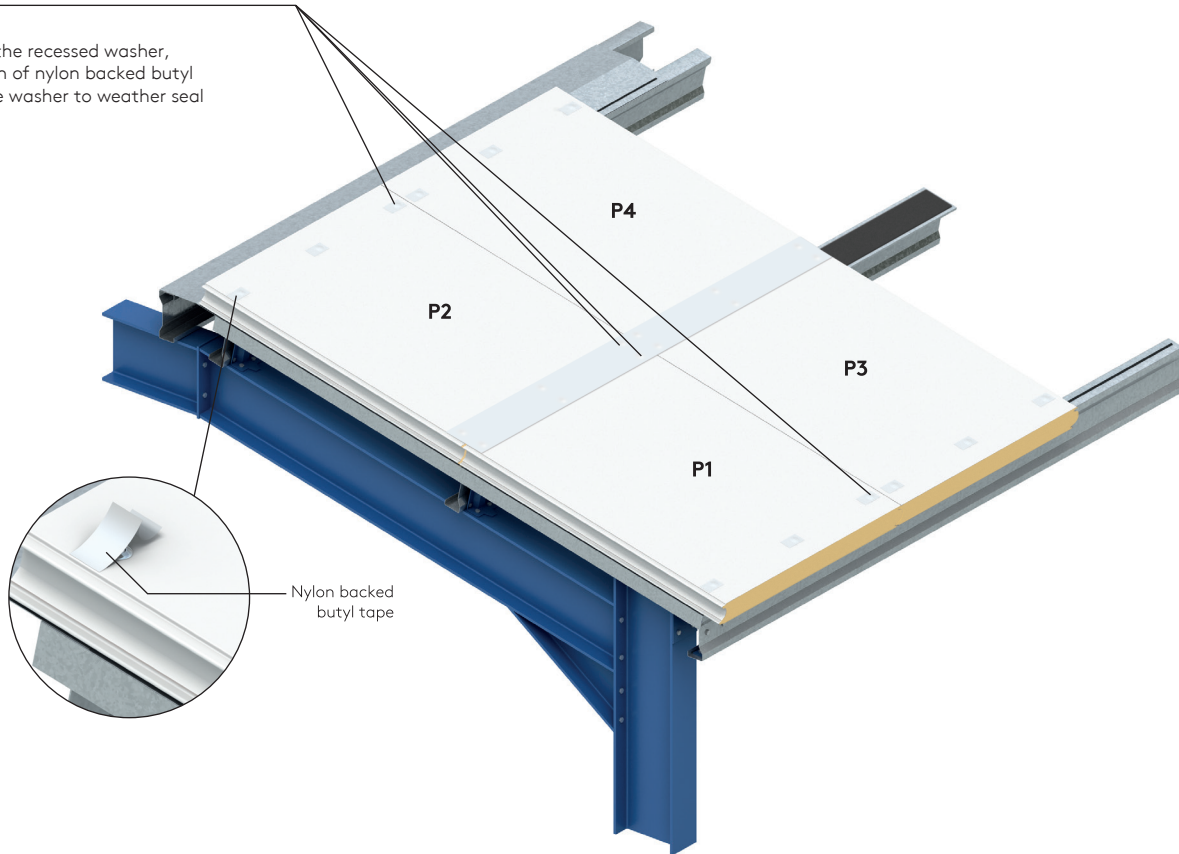

## KS1100/KS1200RL Roofliner Panel

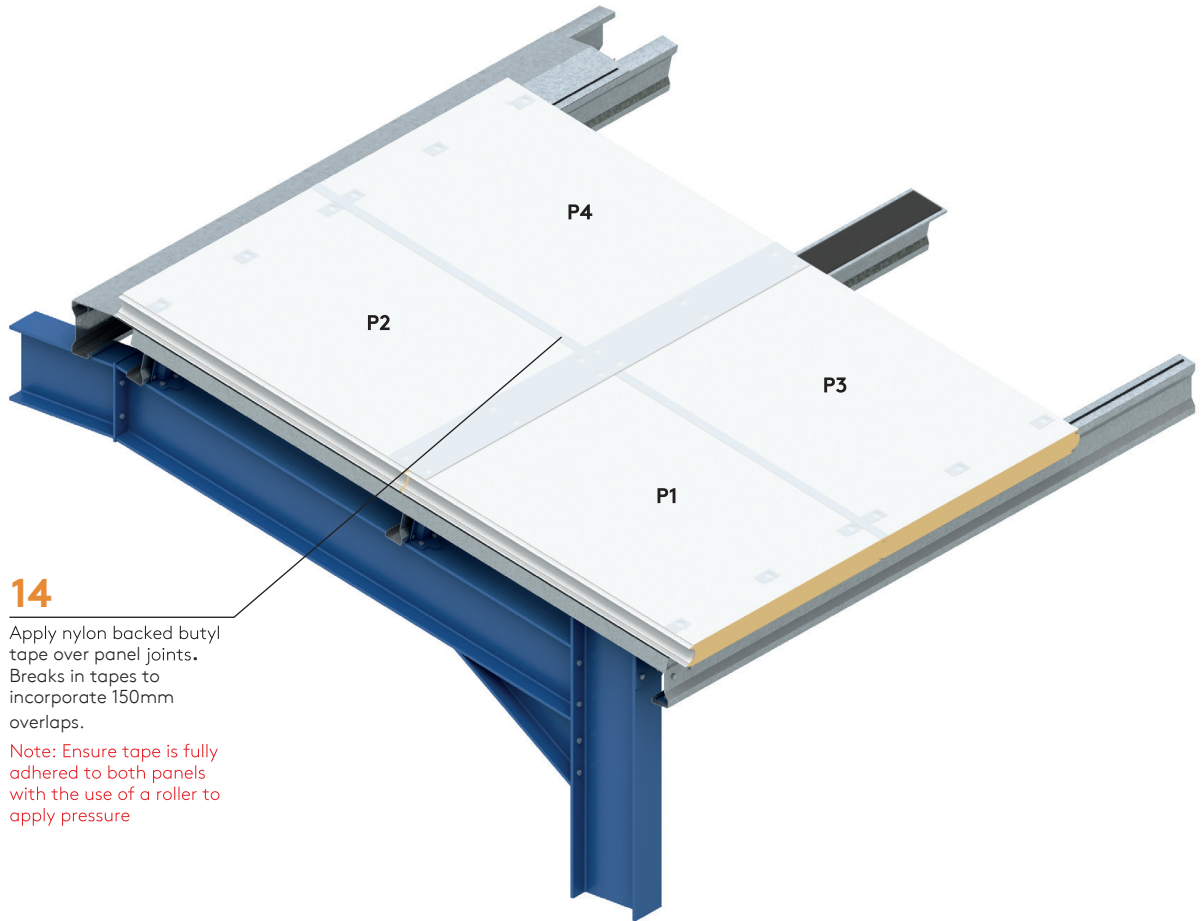

**14**

Apply nylon backed butyl tape over panel joints. Breaks in tapes to incorporate 150mm overlaps.

Note: Ensure tape is fully adhered to both panels with the use of a roller to apply pressure



---

Installation guides are available for most of Kingspan insulated roof and wall panels.  
For the most up to date version of this Installation guide please [click here](#) or scan the QR code below. Alternatively, please call Kingspan on:

AUS: +61 2 8889 3000  
[www.kingspanpanels.com.au](http://www.kingspanpanels.com.au)



For the product offering in other markets please contact your local sales representative or visit [www.kingspanpanels.com](http://www.kingspanpanels.com)

Care has been taken to ensure that the contents of this publication are accurate, but Kingspan Insulated Panels and its subsidiary companies do not accept responsibility for errors or for information that is found to be misleading. Suggestions for, or description of, the end use or application of products or methods of working are for information only and Kingspan Insulated Panels and its subsidiaries accept no liability in respect thereof.

Second Issue | 27/06/2024

Please scan for the most up to date version of this Installation Guide.

