



GOOD  
DESIGN  
AWARD®  
WINNER

DECOR  
SYSTEMS

# CONTOURS OF COUNTRY

ACOUSTIC  
PANELS



SOUND

NRC  
0.70



CONTENTS	
Contours of Country in Use	02
Profile Options	07
Finishes	09
Substrates	09
Recommended Fixing Method	10
Compliance	11
Build Your Specification	12

# Contours of Country has involved working closely with four Indigenous artists to develop a series of designs for use on our Zen panels.

Artists Toby Bishop, Keisha Leon, Rachael Sarra and Jenna Lee have each developed works that are a subtle reminder of the interconnectedness and deep respect for Country and belonging.

The Artworks talk to the many landscapes across so-called Australia and provide a narrative that explores Indigenous knowledge, innovation and efficiency and provides a beautiful opportunity to tell the stories of the traditional owners of the land that we live and build on today.

15% of every sale will be returned to the artist. The range of acoustic products is Group 1 and 2 fire rated and achieves high acoustic performance results.

Contours of Country is a Good Design Award Winner for 2023.



TOBY BISHOP  
RUNNING WATER



JENNA LEE  
SEEDS



KEISHA LEON  
CONNECTIONS IN COUNTRY

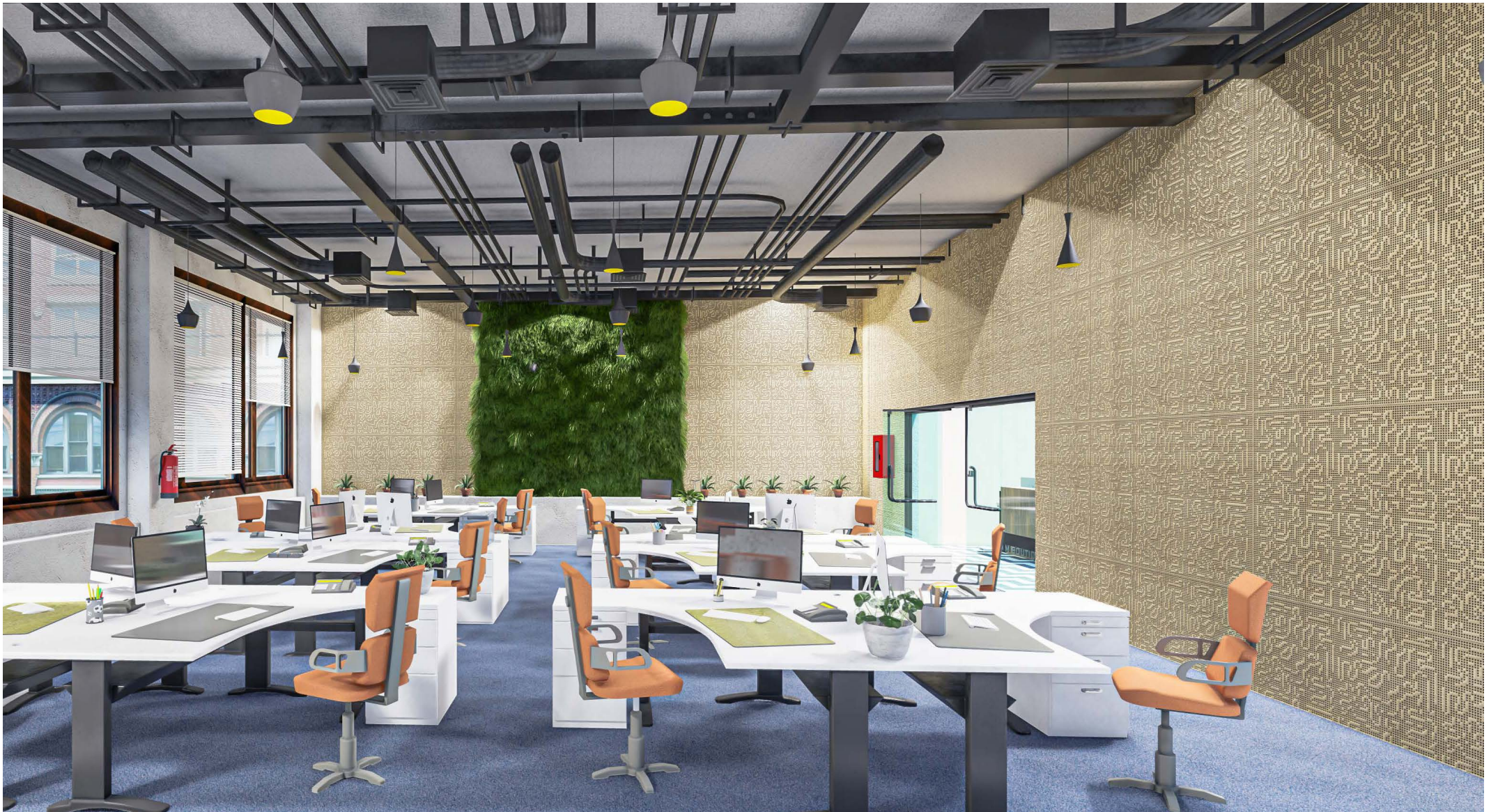

RACHAEL SARRA  
TURTLE SEASON



TOBY BISHOP  
RUNNING WATER

# CONTOURS OF COUNTRY OPTIONS

SOUND

NRC  
0.70

## 01 – PROFILE

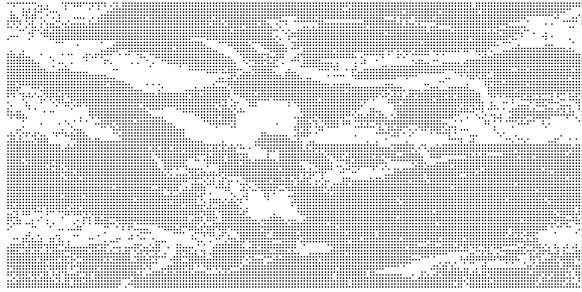

Jenna Lee – Bark



Jenna Lee – Seeds

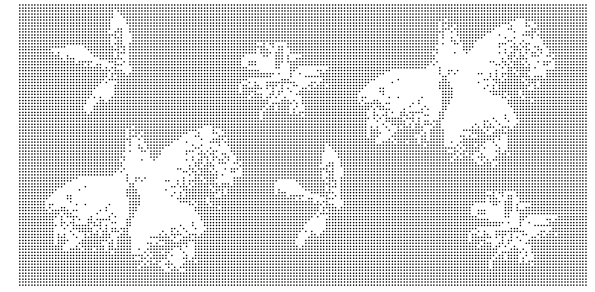

Jenna Lee – Seeds Reversed



Keisha Leon – Connections in Country

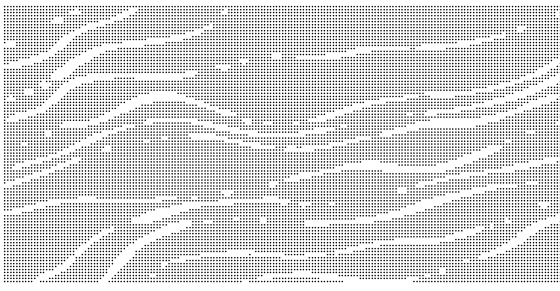

Keisha Leon – Connections in Country Reversed

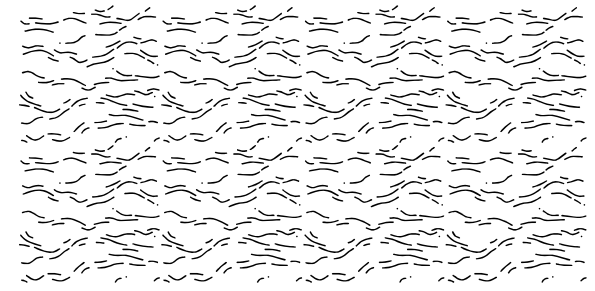

Keisha Leon – Reform



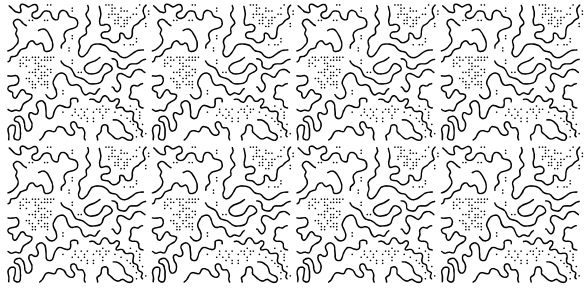

Rachael Sarra – Turtle Season

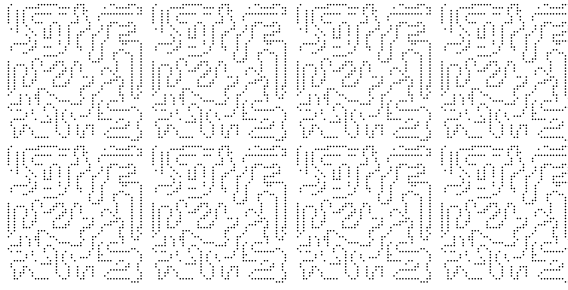

Rachael Sarra – Country Currents

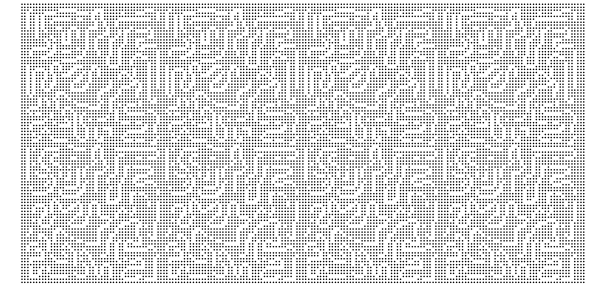

Rachael Sarra – Country Currents Reversed

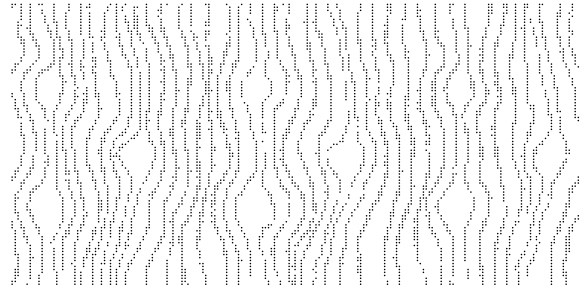

Toby Bishop – Running Water 1A

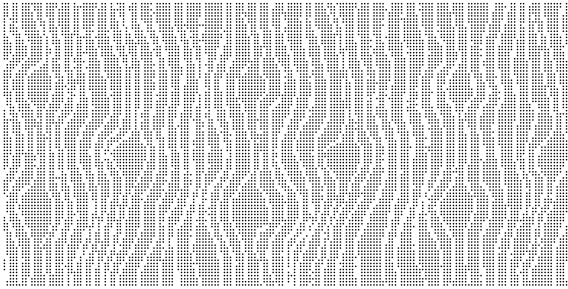

Toby Bishop – Running Water 1A Reversed

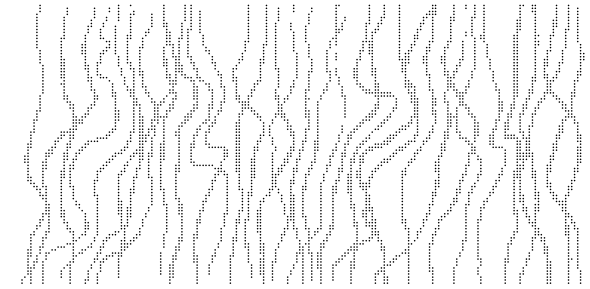

Toby Bishop – Running Water 1B

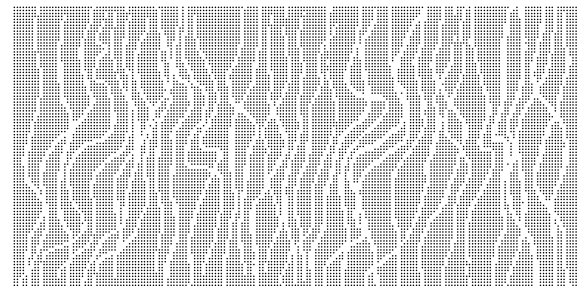

Toby Bishop – Running Water 1B Reversed

## 02 – FINISHES

We have a large range of finishes available for Contours of Country and we are constantly optimising the range by adding and removing options. Please visit the finishes section on our website for the most up to date collection

[View Finishes Online](#)

## 03 – SUBSTRATES



01 FIRE RATED  
MDF



02 MOISTURE  
RESISTANT MDF



03 FSC® MDF

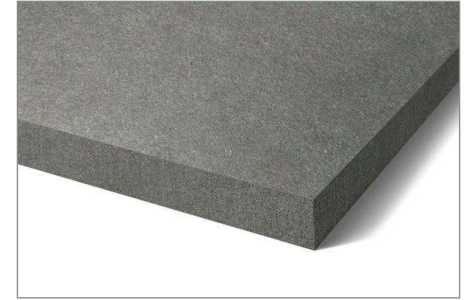

04 FIRE RATED  
CHARCORE MDF



05 BLACK  
CORE MDF



06 FIRE RATED  
BLACK CORE MDF



07 Plywood

# 04 – RECOMMENDED FIXING METHOD

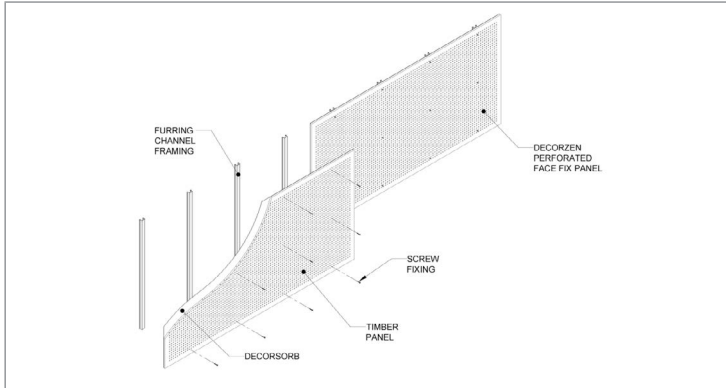

Wall & Ceiling  
Face Fixing

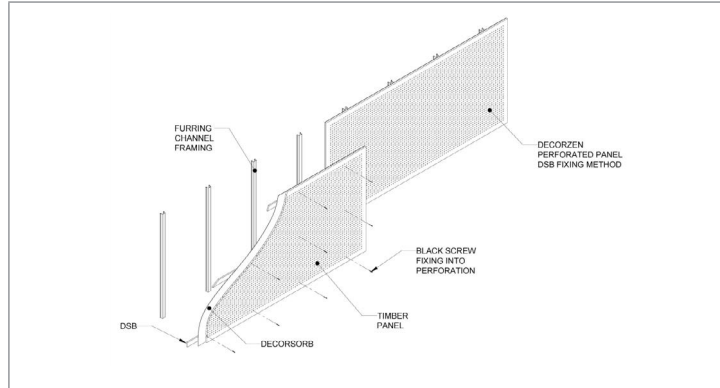

Wall & Ceiling  
DSB Fixing

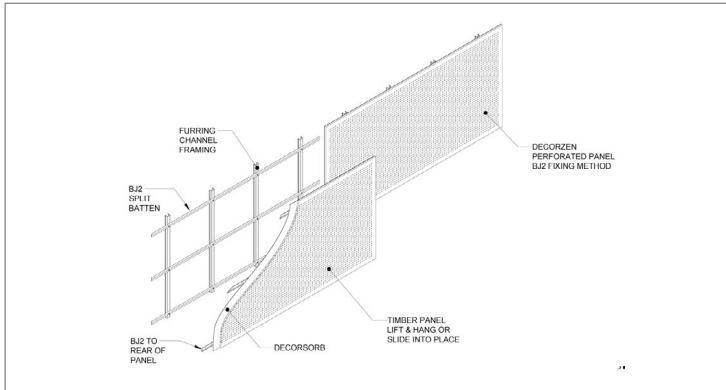

Wall  
BJ2 Fixing

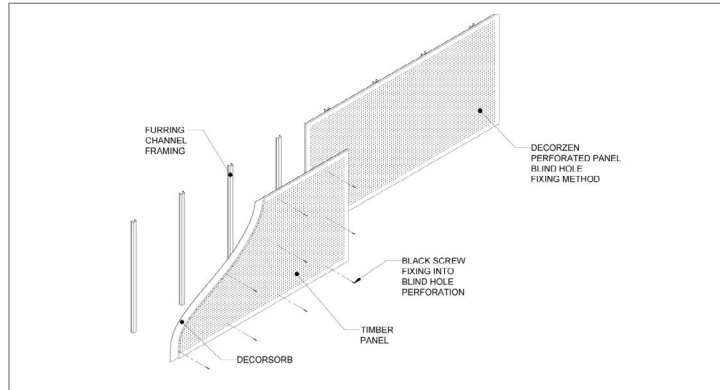

Wall & Ceiling  
Blind Hole

View the installation guidelines for each fixing system on online: [decorsystems.com.au](http://decorsystems.com.au)

# 05 – COMPLIANCE



**Fire Rating**      GROUP 1, 2 OR 3  
**– Natural Timber Veneer**



**Fire Rating**      GROUP 1, 2 OR 3  
**– SmartLook**

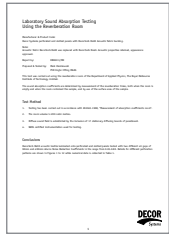

**Acoustic Rating**      0.70 – 0.80



**Environmental Accreditation**      GECA FSC®



**Social Responsibility**      AUSTRALIAN TRUSTED TRADER

[View Certificates Online](#)

\*Environmental accreditations may vary depending on the exact specification.

# CONTOURS OF COUNTRY -BUILD YOUR SPECIFICATION

Complete the table and use the details in your project specification.

PRODUCT	CONTOURS OF COUNTRY	SUPPLIER	DECOR SYSTEMS - PH: 1800 835 035	
PROFILE	(CHOOSE A PROFILE FROM THE LIST ABOVE)			
FINISH	(CHOOSE A FINISH FROM THE LIST ABOVE)			
FINISH VARIATION	(E.G. AMERICAN OAK)			
SUBSTRATE	(CHOOSE A SUBSTRATE FROM THE LIST ABOVE)			
THICKNESS	12MM (STANDARD)	16MM (SUITED FOR SPORTS FACILITIES)		
FIXING METHOD	(CHOOSE A FIXING METHOD FROM THE LIST ABOVE)			
JOINT	EXPRESS (RECOMMENDED)	BUTT JOINT		
EDGING	MATCHING	BLACK	N/A	
BIOPANEL ZAP-X	YES	NO		
DECORINSUL	YES	NO		
FIRE CERTIFICATION	CONTOURS OF COUNTRY COMES WITH A GROUP 2 FIRE RATING. IN SOME CASE, IT CAN ACHIEVE A GROUP 1 CERTIFICATION WHEN A SPECIFIC COMBINATION OF SUBSTRATE AND FINISH IS USED. PLEASE DISCUSS THIS WITH YOUR DECOR SYSTEMS PROJECT CONSULTANT.			
NOTES	(ANY EXTRA INFORMATION YOU WOULD LIKE TO ADD?)			
<p>This product requires an air gap and DecorInsul behind the panels for the best acoustic performance. Consult the acoustic test results, and opinion of project acoustic engineer for more details. If not available due to site constraints or budget, a 50mm gap with DecorInsul works in most cases.</p> <p>Close collaboration between Decor Systems, the project architect and the client has taken place to develop this specification. Contours of Country cannot be substituted unless agreed by Architect and Acoustic Engineer.</p> <p>Panels should be allowed to acclimatise on site for at least five days before installation. Decor Systems certificate # (Contact your Decor Systems project consultant for your individual project number) to be supplied upon completion. Panel installation to be as per manufacturer's instructions and AS/NZS 2785. - Installation to be done by an approved ceiling and partition contractor. Product guarantee to be 99 years as per Decor Systems guarantee. Please contact Decor Systems for your project specific completion number.</p>				

# GET IN TOUCH



CONTACT  
1800 835 035  
letstalk@decorsystems.com.au